

# Inductive coupler M30-1

Axial coupler

Contact free transmission of energy and signals

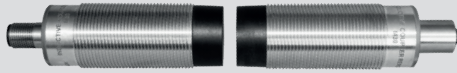

## Application/customer benefits

- Contact free transmission of energy and signals between stationary and moved components
- Application examples: Supply of sensors, supply and monitoring of remote systems, contactless battery charge (W-Charge), monitoring of door contacting, valve control, plug replacement
- Dynamic Pairing
- Free from wear and maintenance
- Operating display

## Technical features

- Mounting M30 x 1.5
- Supply voltage 24V  $\pm$  10%
- Transmission distance 0 - 4 mm
- Transmission of energy: 24V / 12W (500mA)
- Transmission of signals: 1 digital signal
- Inverse-polarity protection (base), short-circuit proof (remote)
- Id. No. Base: OE010980
- Id. No. Remote: OE010981
- Interface: Remote female connector M12 (4-pin), base male connector M12 (4-pin)
- LED interface (base) color: green
  - slow flashing: power on
  - static: in position
  - fast flashing: overload / short circuit

## Block diagram:

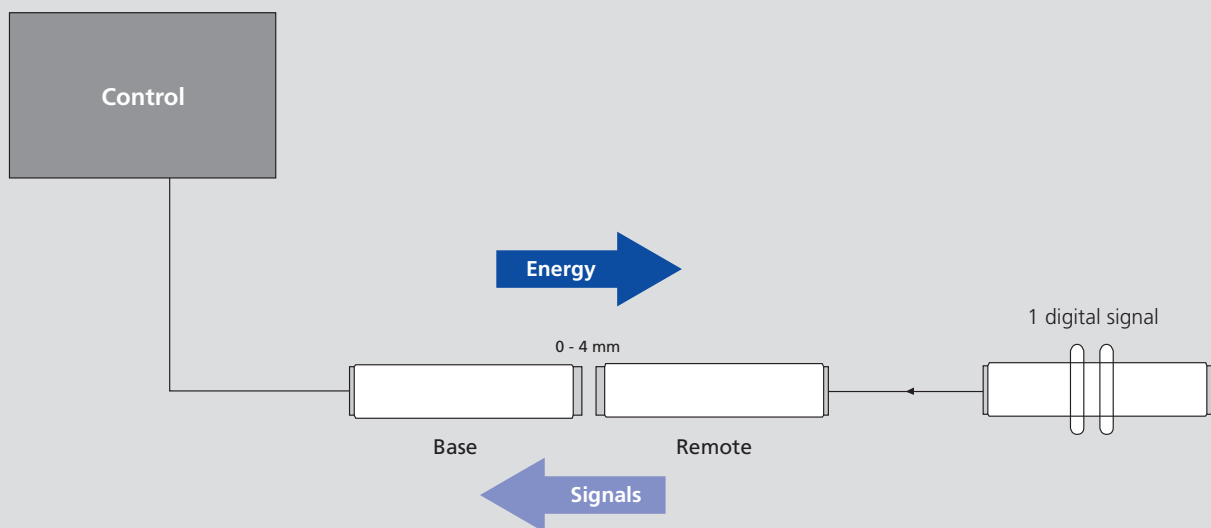

Subject to technical changes.  
For more detailed information please ask our customer service.

# Contact free transmission of energy and signals

# Inductive coupler M30-1

Axial coupler

- Stationary unit - Base
- Mobile unit - Remote

Base:

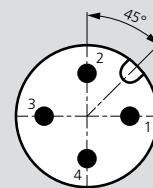
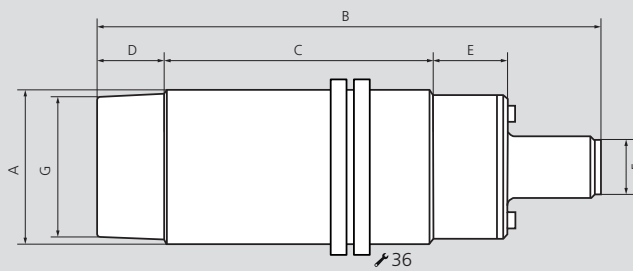

Male connector 4 pin

Remote:

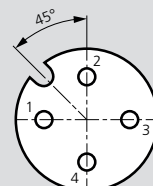
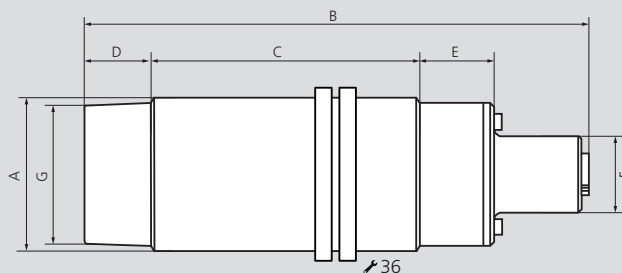

Female connector 4 pin

Subject to technical changes.  
For more detailed information please ask our customer service.

## Inductive coupler M30-1

SMW-Electronics Type		Base	Remote
Id. No.		0E010980	0E010981
A Thread	mm	M30 x 1.5	M30 x 1.5
B	mm	98	98
C	mm	52	52
D	mm	13	13
E	mm	14.5	14.5
F	mm	M12	M12 / Buchse
G	mm	Ø 27	Ø 27
Housing material		CuZn, PA66, PC GF 30%	CuZn, PA66, PC GF 30%
Protection class		IP 67	IP 67
Operating temperature		0°C ... +50°C	0°C ... +50°C
Storage temperature		-10° ... +70°C	-10° ... +70°C
Coupling distance		0 mm ... 4 mm	0 mm ... 4 mm
Operating voltage		24V ± 10% DC	-
Output voltage		-	24V ± 10% DC
Power consumption (Base)		< 500mA	-
Power output (Remote)		-	< 250mA
Overload protection / short circuit protection		✓	✓
Residual ripple		-	< 200mV
Reverse polarity protection		✓	-
Data-Valid Output		max. 100mA	-
Operational readiness		< 100 ms	< 100 ms
PIN assignment		Signal Base	Signal Remote
Supply voltage	1	24V IN	24V OUT
Digital signal	2	PD	PD
Ground connection	3	GND	GND
Data-Valid	4	DAV 24V	-